

V - Fuses

Fuses for Battery Applications, Powered Forklifts and Industrial Vehicles



Voltage Ratings - 36V_{DC} and 80V_{DC}

Current Ratings; 36V_{DC} - 25A - 150A

80V_{DC} - 20A - 500A

Rated Breaking Capacity - $6I_n$, $\tau = 3\text{ms}@48\text{V}_{\text{DC}}$

Standards; DIN 43560 - part 1

DIN 72581- 2

V **Rated Voltage** **Rated Breaking Capacity** **Standard(s)**
 [Un] $6 \times I_n, \tau = 3ms @ 48V_{DC}$ **DIN 43560-part 1**
 80V_{DC}

Size - Form A - Open Frame, Form B - Enclosed Form

Rated current I_n [A]	Form A 80V _{DC}	Form B 80V _{DC}	Weight [kg / 100]		Cold resistance	Power loss
	Article Number	Article Number	9003005	9005805	[mΩ]	[W]
20	9003005.20	9005805.20	0.4	2.0	3.00	1.3
25	9003005.25	9005805.25	0.4	2.0	1.75	1.4
35	9003005.35	9005805.35	0.4	2.0	1.50	2.2
40	9003005.40	9005805.40	0.4	2.0	0.96	1.8
50	9003005.50	9005805.50	0.4	2.0	0.96	3.1
63	9003005.63	9005805.63	0.4	2.0	0.71	3.6
70	9003005.70	9005805.70	0.4	2.0	0.57	3.5
80	9003005.80	9005805.80	0.4	2.0	0.57	5.0
100	9003005.100	9005805.100	0.4	2.0	0.45	6.0
125	9003005.125	9005805.125	0.4	2.0	0.37	6.7
135	9003005.135	9005805.135	0.4	2.0	0.37	8.0
150	9003005.150	9005805.150	0.4	2.0	0.24	7.4
160	9003005.160	9005805.160	0.4	2.0	0.24	9.2
175	9003005.175	9005805.175	0.4	2.0	0.24	11
180	9003005.180	9005805.180	0.4	2.0	0.24	12
200	9003005.200	9005805.200	0.4	2.0	0.17	11
225	9003005.225	9005805.225	0.4	2.0	0.15	14
250	9003005.250	9005805.250	0.4	2.0	0.14	14
275	9003005.275	9005805.275	0.4	2.0	0.14	16
300	9003005.300	9005805.300	0.4	2.0	0.13	18
315	9003005.315	9005805.315	0.4	2.0	0.13	19
325	9003005.325	9005805.325	0.4	2.0	0.1	17
355	9003005.355	9005805.355	0.4	2.0	0.1	26
375	9003005.375	9005805.375	0.4	2.0	0.07	37
400	9003005.400	9005805.400	0.4	3.0	0.07	39
425	9003005.425	9005805.425	0.4	3.0	0.07	41
500	9003005.500	9005805.500	0.4	3.0	0.06	—

Units per Package	
100	20

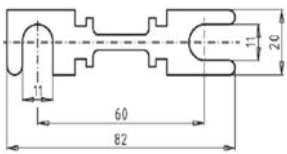

9003005

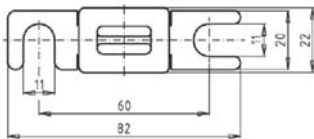

9005805

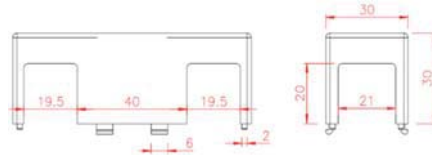
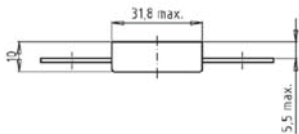

Cover Article No. - 9903001-C

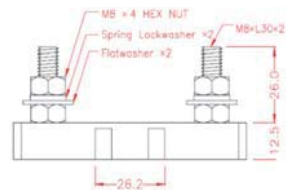
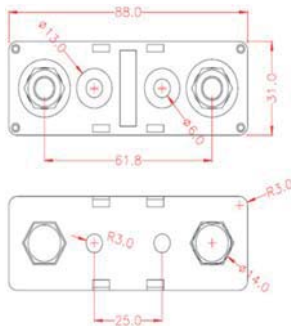

Fuse base Article No - 9903001-B

V	Rated Voltage [Un] 80V _{DC}	Rated Breaking Capacity	Standard(s) DIN 43560-part 1
Size - Form A - Open Frame, Frame B - Enclosed Form			

Time-Current Characteristics

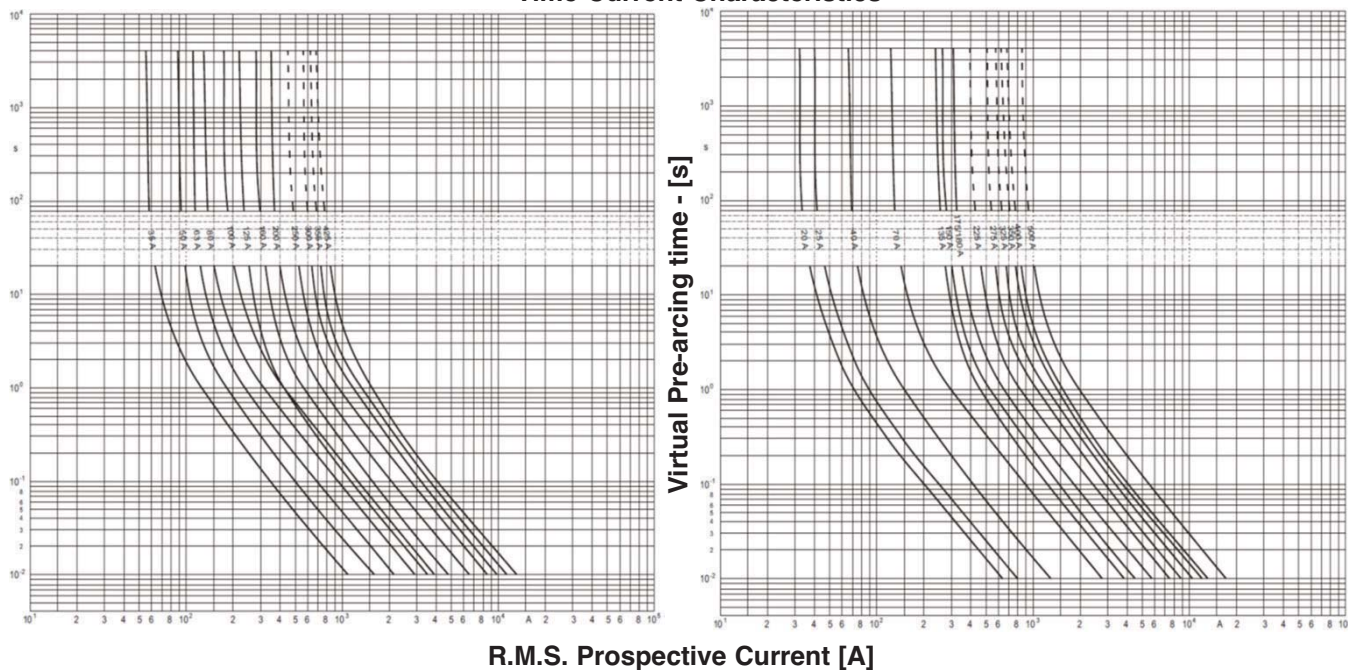

V **Rated Voltage** **Rated Breaking Capacity** **Standard(s)**
 [Un] **DIN 72581-part 2**
 36V_{DC}
 80V_{DC}

Size - Form A - Open Frame, Frame B - Enclosed Form

Rated Current <i>I_n</i> [A]	Form A 36V _{DC}	Form B 80V _{DC}	Weight [kg / 100]		Cold Resistance	Power Loss
	Article Number	Article Number	9005409	9005909	[mΩ]	[W]
25	9005409.25	9005909.25	0.025	0.39	1.75	1.4
30	9005409.30	9005909.30	0.025	0.39	1.62	1.9
35	9005409.35	9005909.35	0.025	0.39	1.50	2.2
40	9005409.40	9005909.40	0.025	0.39	0.96	1.8
50	9005409.50	9005909.50	0.05	0.39	0.96	3.1
63	9005409.63	9005909.63	0.05	0.39	0.71	3.6
80	9005409.80	9005909.80	0.11	0.39	0.57	5
100	9005409.100	9005909.100	0.4	0.39	0.45	6.0
125	9005409.125	9005909.125	0.4	0.49	0.37	6.7
150	9005409.150	9005909.150	0.4	0.49	0.24	7.4
Units per Package						
	100	40				

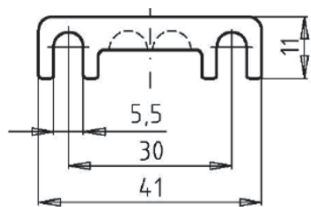

9005409

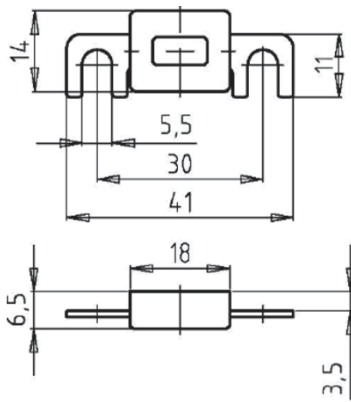

9005909

Time-Current Characteristics

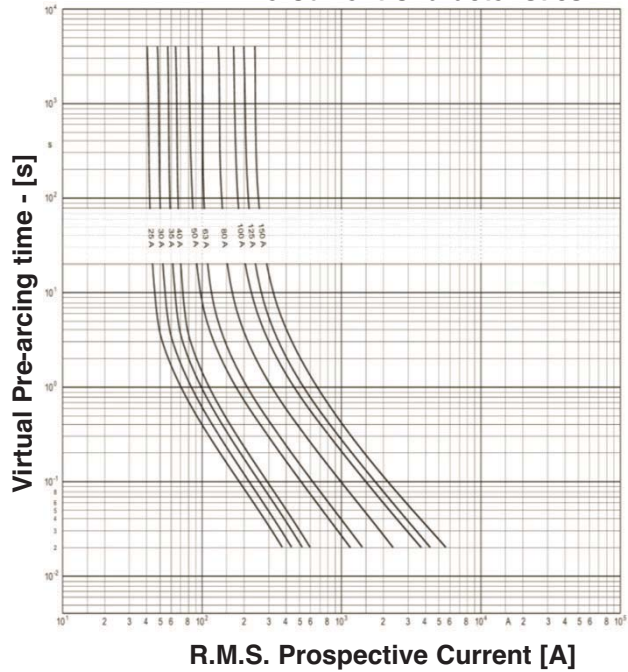

R.M.S. Prospective Current [A]